

Addendum - 2 February 2006

Previously this project was named 'Harbour Bridge to City' project and there may be references in this document referring to this name or its abbreviation: HBTC.

The name of this project has since changed and is now referred to as 'Vic Park Tunnel'. Therefore, any reference to 'Harbour Bridge to City' or HBTC should now be taken to refer to Vic Park Tunnel or VPT.



LEGEND

- PROPOSED DESIGNATION BOUNDARY
- AREAS SUBJECT TO EARTHWORKS

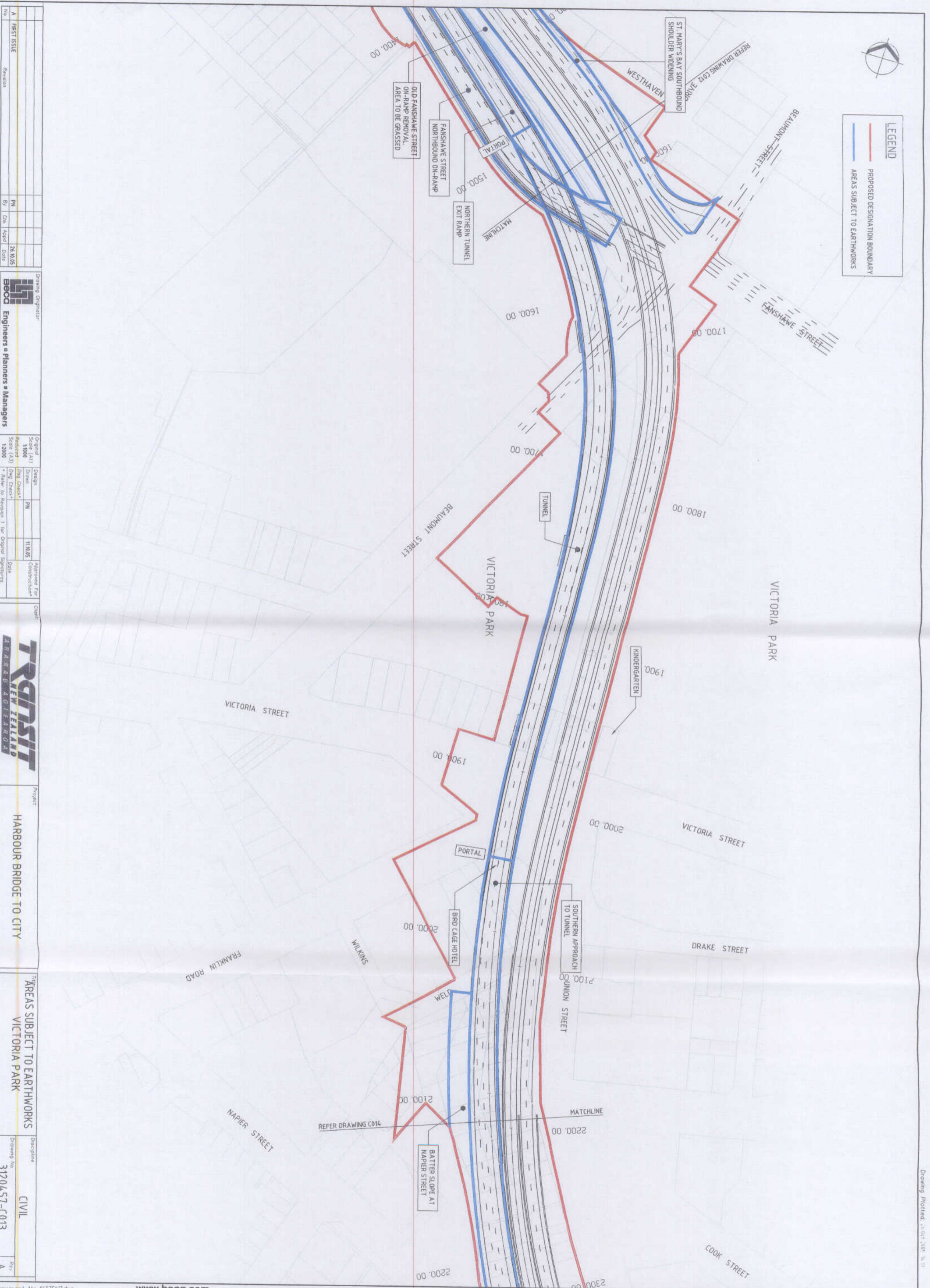

No.	Revision	By	CA	Appr.	Date
A	FIRST ISSUE	PN			26.03.05

Drawing Originator	Scale (A1)	Design	Approved For
BECA Engineers • Planners • Managers	1:1000	Drawn	Construction*
	1:2000	Checked	Date



Project: HARBOUR BRIDGE TO CITY

AREAS SUBJECT TO EARTHWORKS
VICTORIA PARK

Discipline	Rev.
CIVIL	A
Drawing No.	3120457-C013