

## Addendum - 2 February 2006

Previously this project was named 'Harbour Bridge to City' project and there may be references in this document referring to this name or its abbreviation: HBTC.

The name of this project has since changed and is now referred to as 'Vic Park Tunnel'. Therefore, any reference to 'Harbour Bridge to City' or HBTC should now be taken to refer to Vic Park Tunnel or VPT.

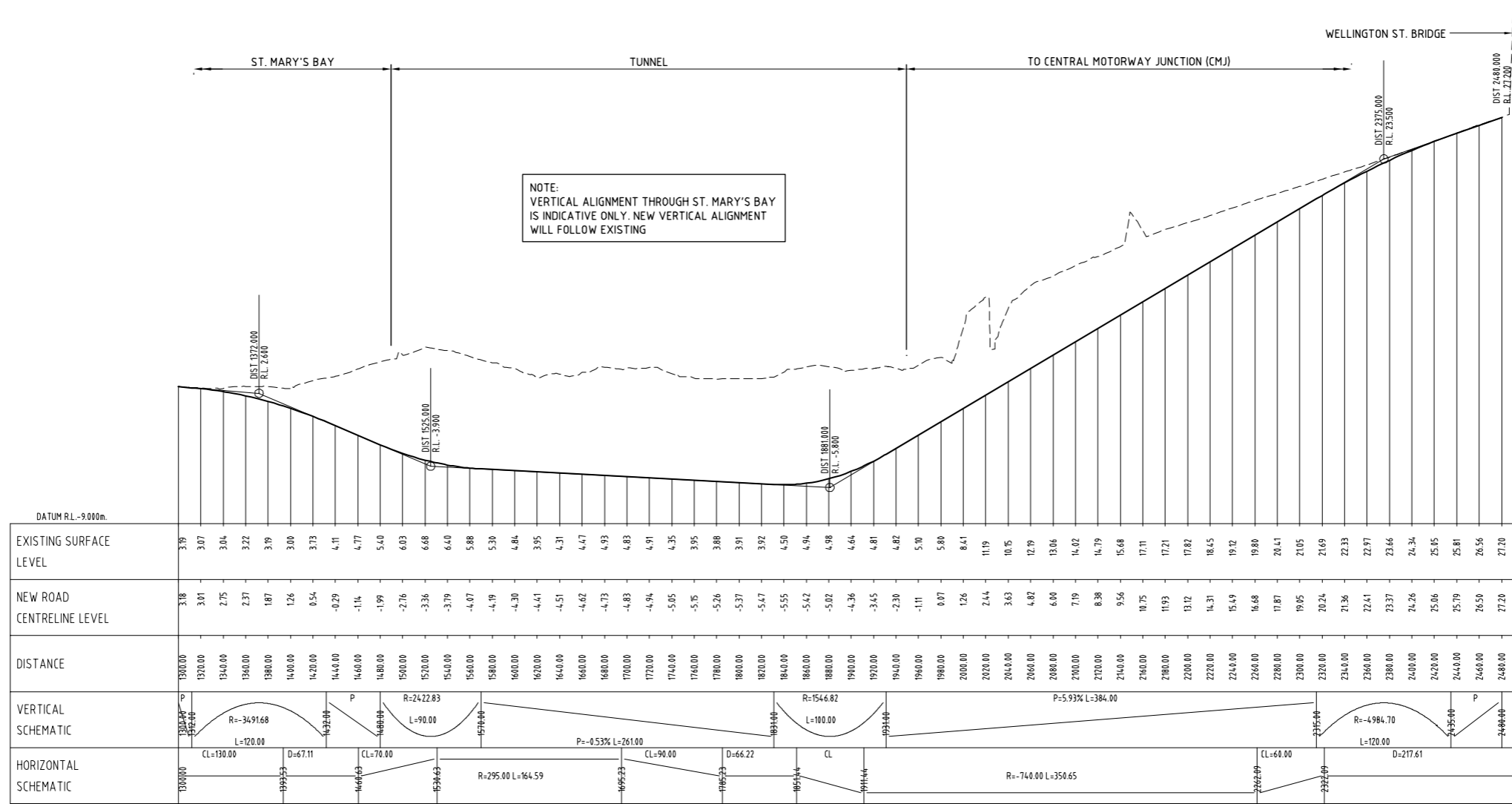

LONGITUDINAL SECTION - NORTHBOUND MOTORWAY CARRIAGEWAY - DIST 1300m TO 2500m

SCALE 1:2500H 1:500V

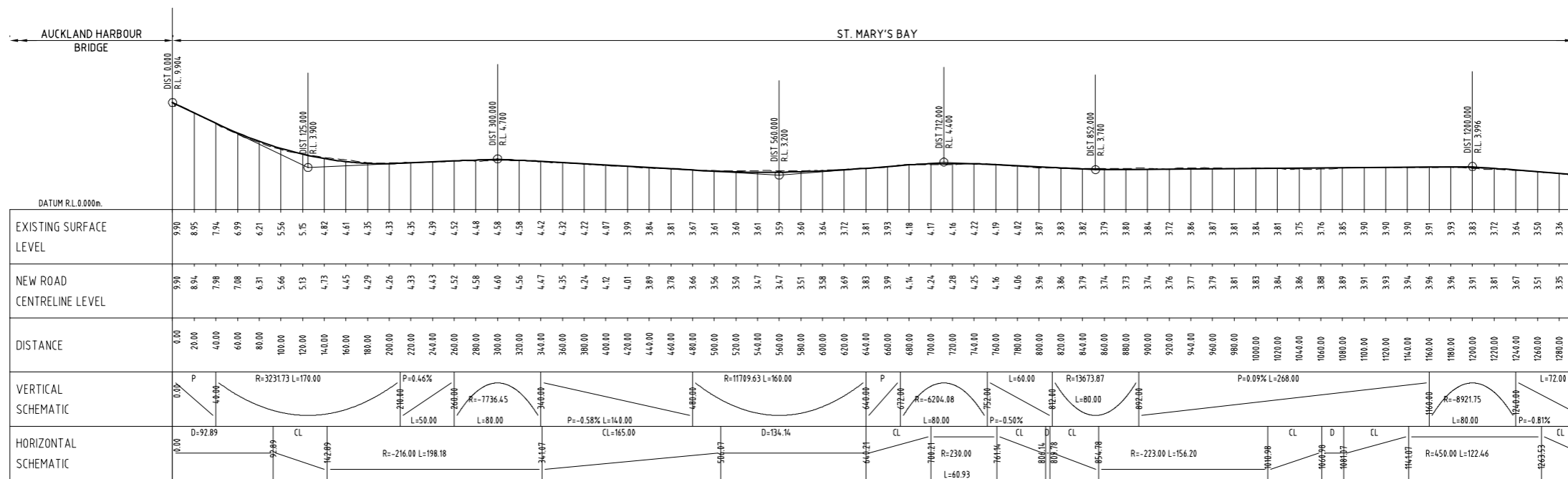

LONGITUDINAL SECTION - NORTHBOUND MOTORWAY CARRIAGEWAY - DIST 0m TO 1300m

SCALE 1:2500H 1:500V

No.	Revision	By	Chk	Appd	Date
A	FOR NOTICE OF REQUIREMENT	PMI			28.10.05

Drawing Originator:  
**BECO Engineers Planners Managers**

Original Scale (A1)	Design	Drawn	PN	10.05	Approved For Construction*
1:50					
Reduced Scale (A3)	Dwg Check*				Date
1:100					

\* Refer to Revision 1 for Original Signatures

Client: **TRANSIT NEW ZEALAND**  
 ARARAU AOTEAROA

Project: HARBOUR BRIDGE TO CITY DRAWINGS FOR NOTICE OF REQUIREMENT

Title: LONGITUDINAL SECTION NORTHBOUND CARRIAGEWAY DIST 0m TO 2500m

Discipline	CIVIL
Drawing No.	3120457-C221
Rev.	A